

der Wetterhahn

Volume 3 Number 1

The Newsletter of Renfrew Museum

Spring 1990

Farmstead Development Continues

The next phase in the development of the Royer Farmstead centers on the restoration of the milkhouse and smokehouse at Renfrew. Terry Pelton, Renfrew's restoration craftsman, began work on the milkhouse in March. The log second story of this building will be replaced with hand-hewed logs and the roof with hand-split shakes. During this coming spring and summer, Pelton will be available on weekdays to interpret 18th century building techniques for visitors.

While removing the current siding from the milkhouse, many artifacts were located, including pieces of

tanned leather and a wooden object believed to be a beaming horse from the Royer Tannery.

To understand and interpret the past lifeways of the Royer Farmstead, a great deal of research is required into the nature of a pre-1830 Pennsylvania German farmstead. Renfrew is supported in this research by the efforts of the Interpretive Committee and its subcommittee members. The Fahnestock House, Fahnestock Barn, milkhouse, limestone kiln, gristmill, smokehouse and tannery each have a subcommittee. Two of these subcommittees, the smokehouse and the milkhouse, have

completed reports on the activities associated with similar outbuildings on a Pennsylvania German farmstead.

The smokehouse subcommittee (chair Bob North, Barry Donohoe, Doug and Ginny Parks and Dorothy Wetherald) carried out research on the methods for processing meat, making candles and soap, cleaning wool and clothing. The milkhouse subcommittee (chair Linda Zimmerman, June and William Arthur, Andrew Fitz, and staff members Shirley Baker and William Sheppard) researched butter- and cheese-making and the ways in which these processes could be interpreted for the visitor. Subcommittee members will demonstrate some of these processes on Renfrew's Farmstead Day in the fall. Two new members (Mary Henicle, Kaye Ressler) have joined the milkhouse subcommittee. Both groups provided the museum with lists of the utensils needed for interpretation within these outbuildings. The furnishings for the milkhouse are listed on the following page.



photo by William Sheppard

The log second story of the milkhouse shown after vertical siding was removed.

MILKHOUSE FURNISHING LIST

BUTTER-MAKING

Sour cream tub
Round shallow tubs (with lids)
— of wood/brass/pottery
Wooden bowls (trenchers)
Cream stirrer
Milk dipper
Skimmers — brass
Earthenware cream pots
Barrel churn
Butter stand
Butter paddles
Butter scoops
Butter molds and prints
Oak tubs to store butter — firkin
Salt bowls
Butter boxes
Scales
Butter tamp (wooden)

CHEESE-MAKING

“Cheeselep” (jar or bag) to hold rennet
Wooden paddles
Curd knife (long wooden knife)
Cheesecloth
Wooden cheese drainer
Lever cheese press
— “Hoop and foller”
— Leaching or cheese board

Renfrew is seeking the loan or donation of these items to help with our interpretation of the milkhouse. Anyone interested, please contact Shirley Baker at 762-4723 or 762-0373.

Research on Nicodemus Collection

One responsibility of Renfrew's staff is to update information on the pieces within the Nicodemus collection. This is an ongoing process which is often aided by members of the museum. The following research on the Elizabeth Jacobs quilt was conducted by E. Emery.

Elizabeth Jacobs

Elizabeth Jacobs was born locally on Feb. 9, 1829, the daughter of George Jacobs and Susan Bell. Her father was a farmer whose property was located east of Waynesboro, near the site of Renfrew. He also represented Franklin County in the Pennsylvania legislature in 1857. Susan Bell was the daughter of Fredrick and Maria (Emerick) Bell. Fredrick Bell was the older brother of Peter Bell Jr. and the uncle of Waynesboro's local potter, John Bell. George and Susan Jacobs had seven daughters.

When she was 35 years old, Elizabeth Jacobs married

Daniel Tritle on May 24, 1864. Daniel Tritle farmed for a short time and also clerked in several hardware stores. He served as a director for both Frick Co. and the First National Bank. The Tritles had three children and their descendants are still living in the Waynesboro area.

The Elizabeth Jacobs Quilt

Elizabeth was 21 years old in 1850 when she made the appliqued, tulip quilt; now on display in the urban bedroom. She is thought to have used the following techniques in making the quilt: applying small pieces of fabric onto the top of a background fabric, she would have turned the ragged edges under, possibly with a piece of tin or cardboard to hold the pattern. The flowers, leaves and other designs were cut from printed material. Intricate appliqued quilts were popular between 1830 and 1900.

Data researched by E. Emery

1990 Calendar

Saturdays in April & May

Birdwalks at Renfrew

Each Saturday morning during April and May, Willard Rahn will lead birdwalks along the hiking trails at Renfrew. The walks will begin at Renfrew's lower parking lot off Welty Road; participants are asked to bring identification books, binoculars and hiking shoes.

Saturday, April 22

Noon - 5 p.m.

Earth Day 1990

A number of special events are planned to celebrate the 20th anniversary of Earth Day, including: a school clothesline exhibit, Peace Ribbon display and activity, Earth Cake tasting, students from Beckie's Dance Studio performing Stravinski's "Rite of Spring," Slim Harrison presenting a bluegrass concert, video presentations on "Chesapeake Bay Challenge" and "Our Threatened Heritage," exhibits on environmental issues and outdoor resources and games. Admission is free.

Saturday & Sunday, April 28 & 29

Noon - 4:30 p.m. Saturday

1 to 5 p.m. Sunday

Springfest Weekend

Renfrew opens officially for the 1990 season with two days of festivities featuring craft demonstrations, musical entertainment and special activities, including: hayrides, free tours of the museum, games and a sing-along for children, a herb sale by Alloway Gardens, face painting, a Maypole dance and demonstrations of quilting, rug hooking, tole painting and other crafts. Admission is free.

Saturday & Sunday, May 12 & 13

Flower Show

In celebration of Mother's Day, members of Antietam Garden Club will present a flower show at Renfrew.

Saturday, May 19

1:30 to 2:30 pm.

18th Century Midwifery

Sarah Lewis will display the artifacts and explain the practices of 18th Century midwives. Lewis is a founding member of the 18th Century Medical Group associated with Yorktown and a member of the American Association For Historic Medicine. She received her M. A. from University of Maryland, where she wrote her thesis "Collective Biographs of Maryland Surgeons in 1790: Gentlemen of Faculty".

Saturday, June 23

9 a.m. - 8:30 p.m.

Youth Festival

Renfrew's first Youth Festival, co-sponsored by the Renfrew Institute and WA-Plus, will feature a full day of activities for all ages, including entertainment, workshops and youth performances. The day's highlight will be a concert by Billy B., a natural science song-and-dance man, from 7:30 to 8:30 p.m.

1990 Calendar (cont.)

Saturday & Sunday, July 14 & 15

7:30 p.m.

Shakespeare on Wheels

The troupe of actors from the University of Maryland Baltimore County will return to Renfrew with their 1990 rendition of Shakespeare's "As You Like It." The free performances, underwritten by a grant from First National Bank & Trust Co. of Waynesboro, will be presented in the courtyard behind the museum house. Those attending are invited to bring lawn chairs and blankets. Picnic suppers will be on sale with proceeds going to Renfrew Institute.

Friday, Saturday & Sunday, Aug. 10, 11 & 12

Civil War Encampment

Confederate and Union soldiers will set up camp at Renfrew for the weekend. The encampment will be open all day Saturday and until 4 p.m. Sunday, highlighted by a Sunday afternoon skirmish. Admission is free.

Saturday, Sept. 1

10 a.m. - 5 p.m.

Arts & Crafts Market

Members of the Cumberland Valley Craftsmen will display and sell their wares during the annual show. Admission is free.

Saturday, Sept. 29

1 - 4 p.m.

Farmstead Day

Renfrew will celebrate its agricultural roots with the third annual Farmstead Day. Special events will focus on the development of the museum's Royer Farmstead. Admission is free.

Saturday, Nov. 17

10 a.m. - 1 p.m.

Open Hearth Thanksgiving

Shirley Baker, director of visitor services at Renfrew, will demonstrate the preparation of a Pennsylvania German Thanksgiving meal during the program in the museum's kitchen. The number of participants will be limited to 12 to 15, pre-registration is required and a fee will be charged.

Friday, Saturday & Sunday, Dec. 7, 8 & 9

Annual Yuletide Celebration

Renfrew Museum will welcome the holiday season with its annual celebration which will open Friday evening with a reception for members of the Renfrew Museum and Park Board of Directors, museum volunteers and members of the area garden clubs who decorate the house for the season. The museum will be open to the public from 2 to 5 p.m. Saturday and 5 to 8:30 p.m. Sunday. Although all are welcome, Saturday's hours are set aside especially for senior citizens and people with special needs. The festivities will include musical entertainment, homemade refreshments and free tours of the museum house. Entries in Renfrew's annual amateur photography competition will be displayed. Admission is free.

Mont Alto Campus Assists in Restoration



Photo by Trish Krim

Ken Swisher, professor at Penn State's Mont Alto Campus, and Terry Pelton discuss how watershed trees will be used in the restoration of the milkhouse.

Several days a week, groups of forestry students walk the woodlands of the Waynesboro watershed. Their instructors, Ken Swisher and James Hale, have spent several decades teaching first- and second-year students from Penn State's Mont Alto Campus the profession of forest management.

Students come away from these courses with training in land management, forest protection, forest inventory, land surveying, conservation, pest management and timber harvesting. Over the last three years, part of their work has included harvesting wood destined for Renfrew. Swisher and his students have cut approximately 2,500 board feet of wood for the restoration of the Royer Farmstead. Renfrew's preservation needs require specific types of trees — red pine, red oak and white oak — and specific-sized trees. In turn, tree selection and harvest require added time and energy by the forestry class.

Spring Exhibit Gets Dirty

In contrast with Renfrew's collection of decorative arts, this spring's exhibit, **Past Under Present**, will feature the *trash* of the Royer Farmstead which was recovered during the archaeological excavations at Renfrew. The exhibit will include material from the Royer Tannery and the Royer-Fahnestock Gristmill, as well as items found during excavations behind the museum house in 1977. Other material located during the renovations of the Fahnestock barn and the milkhouse and from the site of the John Bell pottery on South Potomac Street will also be on display.

Past Under Present will open on Saturday, April 28, in Renfrew's Changing Gallery and run through mid-July.

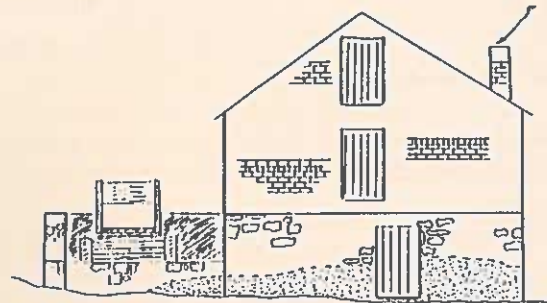

Drawing by W. J. Sheppard

A reconstructive drawing of the southern elevation of the Royer-Fahnestock Gristmill (c.1807-1881).

(Editor's note: Renfrew wishes to thank the members of the Cumberland Valley Archaeology Society for their assistance during the excavation of the Royer-Fahnestock Gristmill site and for their help in mounting the spring exhibit.)

Baker Named Director of Visitor Services

The Board of Directors of Renfrew Museum and Park recently announced the appointment of Shirley Baker, formerly the assistant to the curator, to the new position of director of visitor services. Within this post, Baker's duties will include planning the museum's annual programs and activities, directing and coordinating Renfrew's volunteer program and continuing the development of the Friends of Renfrew membership.

Baker reported that the museum has received its first three life memberships and that nine new volunteers may join Renfrew this year. Baker hopes that the new volunteers will provide as much fresh input as the present volunteers have given over their years of service.

Anyone interested in museum programming or in volunteering are encouraged to contact Baker at 762-4723 or 762-0373.

In Memorium Helen Hoover Hoffman

(1910 - 1990)

Mrs. Helen Hoover Hoffman, a member of the Renfrew Board of Directors, died on Wednesday, March 14th at age 79. As one of the original trustees, she served on the Board of Renfrew from the very first day the museum began operations in 1973. She was elected the first secretary of the Board, an office she held continuously until her death. In January of this year, she was appointed to the Board of the Renfrew Institute for Cultural and Environmental Studies.

Helen Hoffman was committed to Renfrew and dedicated to its well-being. She never flinched from her responsibilities as a trustee; she served in our trust. She was at times tough and impassioned in her views and her defense of Renfrew. I knew her as a woman of grace and charm and as a woman of good cheer. Few have served Renfrew so well; she will be missed.

James M. Smith, Curator

der Wetterhahn

Renfrew Museum 1010 East Main St. Waynesboro, PA 17268

Non-profit org.
U.S. Postage
PAID
Waynesboro, PA 17268
Permit No. 233